

# RIVERSIDE LOGISTICS CENTER

BY TRANSWESTERN DEVELOPMENT COMPANY



FOR LEASE  
**±307,394 SF**

3650 CENTER STREET,  
RIVERSIDE, CA 92501

**Hunter McDonald**

Lic.# 01879029

E: hunter.mcdonald@jll.com

P: +1 909 467 6873

**Dya Navarrete**

Lic.# 02078833

E: dya.navarrete@jll.com

P: +1 909 467 6875

**Patrick Wood**

Lic.# 01776274

E: patrick.wood@jll.com

P: +1 909 467 6857

**Chase Berry**

Lic.# 02196093

E: chase.berry@jll.com

P: +1 909 467 6872

**Brian Thene**

Lic.# 02090362

E: brian.thene@jll.com

P: +1 909 467 6859



# PROPERTY FEATURES

**RIVERSIDE**  
LOGISTICS CENTER



**±307,394**  
SF Building



**±9,444**  
SF Office and  
Mezzanine



**L-Shaped**  
Cross Dock  
Configuration



**36'**  
Clear  
Height



**56' x 50'**  
Typical Column  
Spacing



**2 Access Points**  
Of Ingress  
& Egress



**Electric Truck**  
Charging  
Ready



**200' Truck**  
Court Depth



**Secured**  
Truck Court



**63 Dock**  
High Doors



**2 Grade**  
Level Doors



**259 Auto**  
Parking Stalls



**40 Dedicated**  
Trailer Stalls



**ESFR**  
Sprinkler System





# LOCATION MAP & AERIAL

**RIVERSIDE**  
LOGISTICS CENTER





# PROPERTY RENDERING

**RIVERSIDE**  
LOGISTICS CENTER





# CONCEPTUAL SITE PLAN

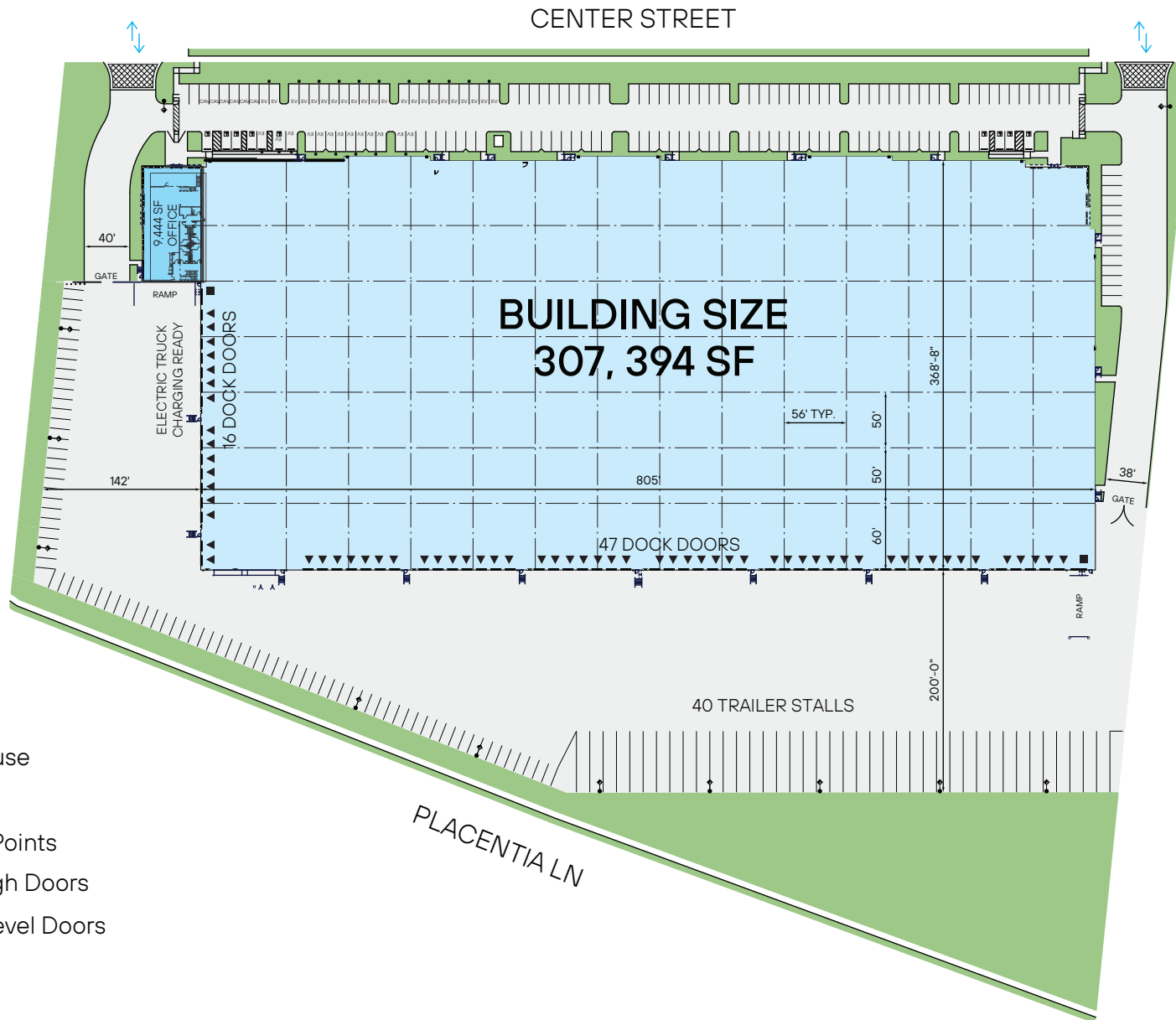

- Warehouse
- Office
- Access Points
- Dock High Doors
- Grade Level Doors

Parking spaces are approximate and to be verified. All site and building features illustrated are to be verified; they are estimated and are not to scale.

# TRANSPORTATION & INTERMODAL MAP



## FREEWAYS



I-215	0.7 mi
CA-60	2.2 mi
I-10	3.8 mi

## AIRPORTS



Ontario International Airport	17.1 mi
Los Angeles International Airport	71.6 mi

## INTERMODAL/PORTS



UP Intermodal Yard	4.1 mi
Ports of Los Angeles & Long Beach	71.6 mi





# RIVERSIDE LOGISTICS CENTER

FOR LEASE  
±307,394 SF



### Hunter McDonald

Managing Director

Lic.# 01879029

E: hunter.mcdonald@jll.com

P: +1 909 467 6873

### Patrick Wood

Executive Managing Director

Lic.# 01776274

E: patrick.wood@jll.com

P: +1 909 467 6857

### Brian Thene

Vice President

Lic.# 02090362

E: brian.thene@jll.com

P: +1 909 467 6859

### Dya Navarrete

Analyst

Lic.# 02078833

E: dya.navarrete@jll.com

P: +1 909 467 6875

### Chase Berry

Analyst

Lic.# 02196093

E: chase.berry@jll.com

P: +1 909 467 6872



Although information has been obtained from sources deemed reliable, neither Owner nor JLL makes any guarantees, warranties or representations, express or implied, as to the completeness or accuracy as to the information contained herein. Any projections, opinions, assumptions or estimates used are for example only. There may be differences between projected and actual results, and those differences may be material. The Property may be withdrawn without notice. Neither Owner nor JLL accepts any liability for any loss or damage suffered by any party resulting from reliance on this information. If the recipient of this information has signed a confidentiality agreement regarding this matter, this information is subject to the terms of that agreement. © 2023 Jones Lang LaSalle IP, Inc. All rights reserved.